



Crestchic Loadbanks
WORLDWIDE LOADBANK SPECIALISTS



3.3MVA

Resistive/ Reactive Loadbank

50Hz - 60Hz Capable
10'x8' ISO Container

Ultra Compact Weather Proof Enclosures

- Operates in all weather conditions

Excellent Control Options

- Control via laptop computer or hand held controller
- Up to 300' of control cable

Programmable with Printed Documentation

- Program your load test in advance
- Record and save test data for end users

Flexibility

- Load banks link together with one control cable to work as one unit with one set of controls
- Minimum load steps of 1 kW and 1 kVAR
- Fully adjustable power factor

Unmatched Transportability

- Designed to withstand the rigors of portable applications and severe operating environments
- ISO packaging for overseas shipping
- Fork Pockets
- Custom trailers available

NORTH AMERICAN SALES OFFICE
619 758 4188 • www.crestchic.com

3.3MVA RESISTIVE/REACTIVE — Loadbank

SPECIFICATIONS

CAPACITY3.3MVA/2640 KW @ 480 volts, 60 Hz,
3 phase, 0.8 PF Units are linkable for
larger loads

DESIGN VOLTAGE480 volts, 60 Hz May be used in
lower voltages and 50 Hz at
reduced capacity Transformers
available to test high voltage

CONTROL SYSTEM.....Controlled via hand held controller
or PC with printed documentation

MINIMUM LOAD STEPS 1kW, 1kVAR

AMBIENT PARAMETERS Maintains maximum capacity in
ambient conditions up to 120° F,
and 100% humidity

FAN AND CONTROL POWERVia main bus, or 70 amp, 480 volt,
3 phase external source

ENCLOSURES 10' ISO weatherproof container

AIR FLOWSide intake, top exhaust

DIMENSIONS3.3MVA – Height: 8.5', Width: 8.0',
Length: 10.0', Weight: 22,500 lbs.

DIMENSIONS/RENDERING

Materials and specifications are subject to change without notice.

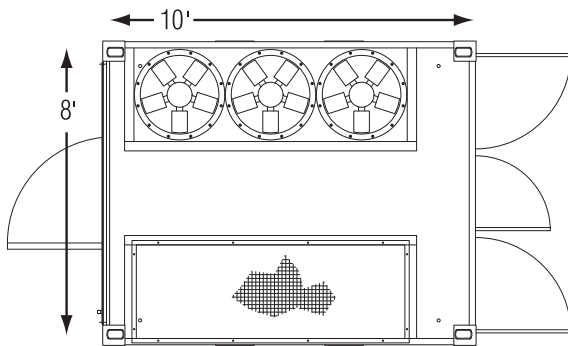

PLAN VIEW / FOOTPRINT
SHOWING DOORS OPENING

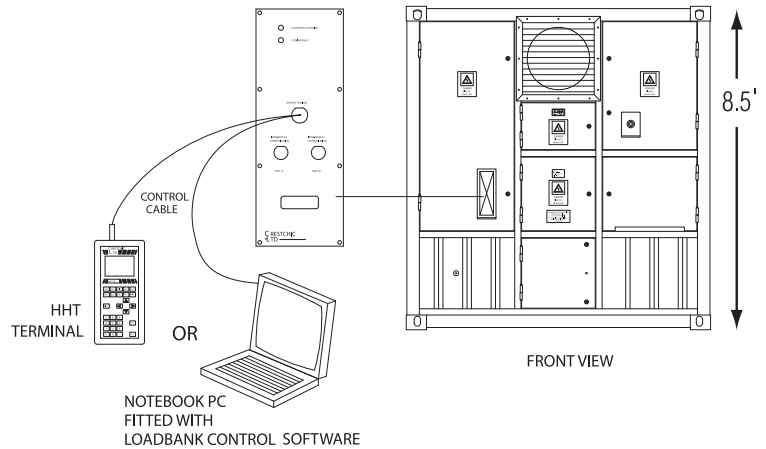

FRONT VIEW

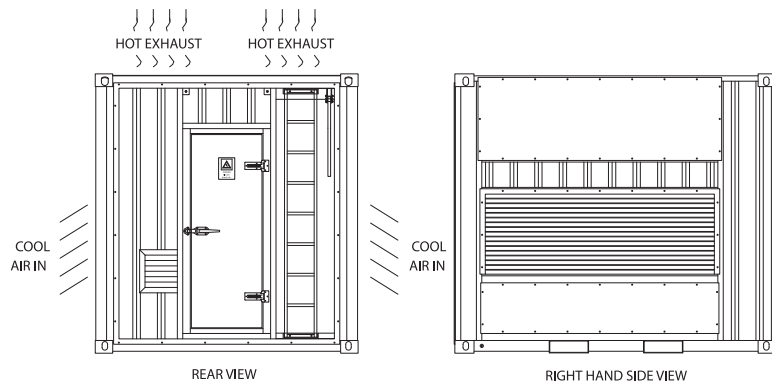

REAR VIEW

RIGHT HAND SIDE VIEW

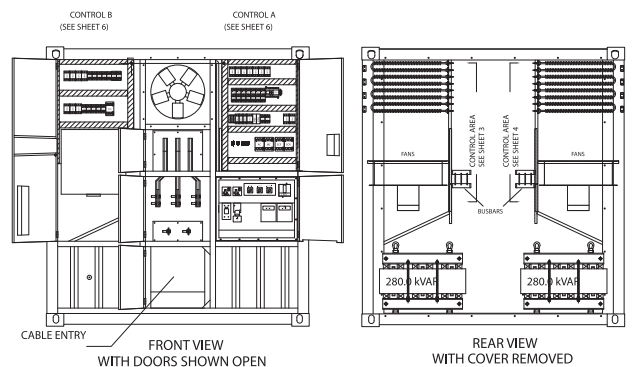

FRONT VIEW
WITH DOORS SHOWN OPEN

REAR VIEW
WITH COVER REMOVED